

Condensate pump EASY FLOW

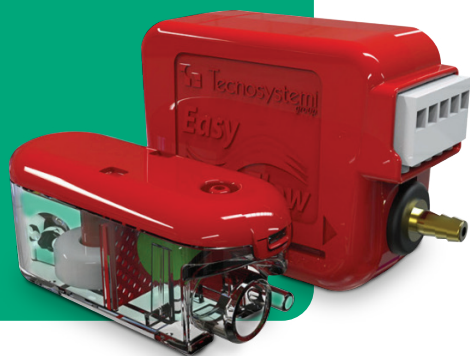

Easy cleaning



Complete set
installation



Quiet,
21 dB(A)



Compact
dimensions



Warranty
2 years

Description

Premium-class condensate pump of extremely compact size, housed in the indoor unit. Quick Plug & Play Installation. Recommended for both wall-mounted split air conditioners as well as commercial air conditioners.

Necessary when gravity drainage of condensate is not possible. Drains the condensate accumulating on the tray under the exchanger and, thanks to its design and equipment, will find use in the most difficult solutions

1. Floating body

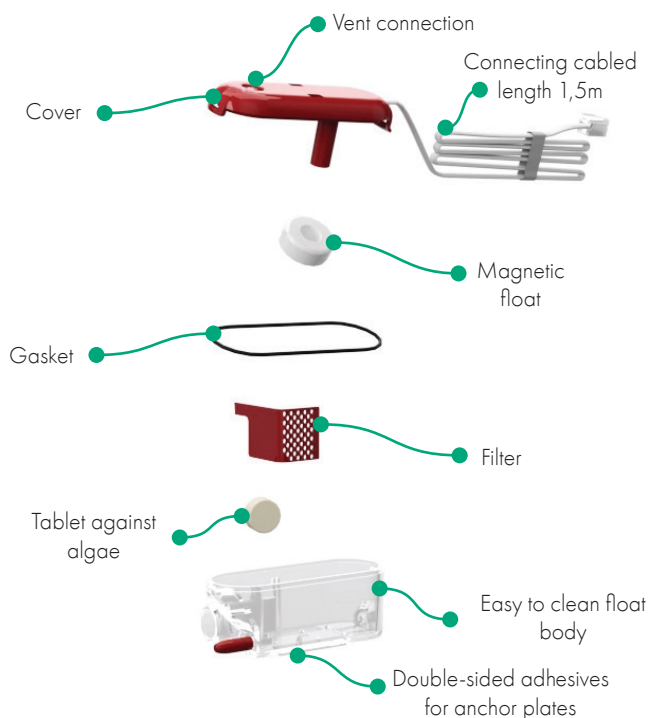

Features

Transparent anti-algae float body

Compact size

Low noise level

Does not transmit vibration

Built-in thermal switch at 80°C

Technical specifications

Max flow rate hourly from 11 to 15 l/h

Power supply 230V - 50Hz

Alarm contact C-NO/NC 8A

Protection rating IP20

Intake max 2 m vertical between floating body and pump

Transparent casing with disinfectant plug to prevent algae formation

Cover with gasket and vent hole

Dimensions

Dimension tube 4 x 6 mm

Dimension pump width 97 x height 55 x depth 30 mm

Float body dimensions length 91 x height 39 x depth 34 mm

2. Pump

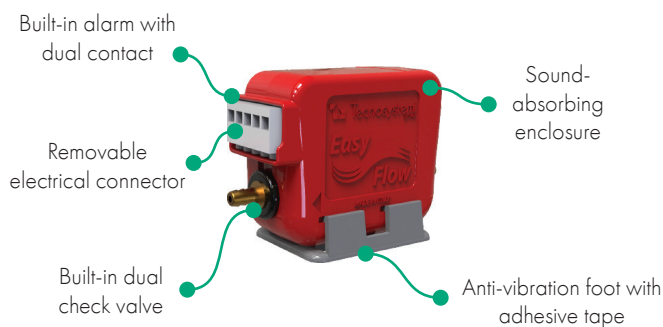

Model EF 11 LT

For air conditioners up to 10 kW

Max. 8 m vertical delivery

Power consumption 19 W

Max noise level 21 [dB(A)]

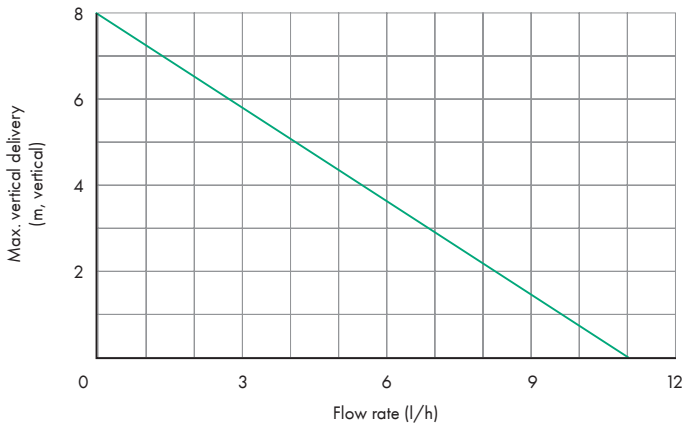

Model EF 15 LT

For air conditioners up to 16 kW

Max. 10 m vertical delivery

Power consumption 19 W

Max noise level 25 [dB(A)]

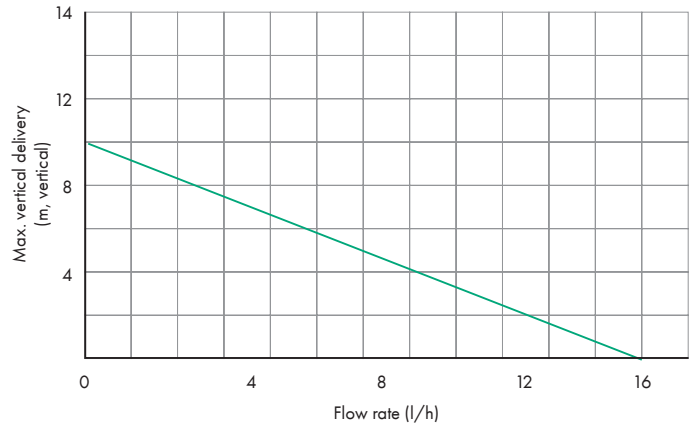

Mounting possibilities

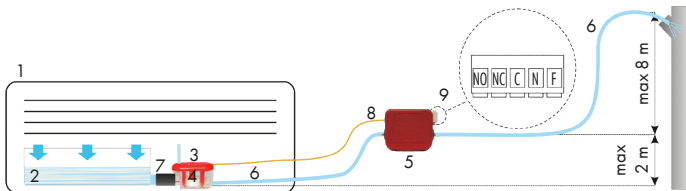

1. Indoor unit
2. Drip tray
3. Vent connection
4. Transparent anti-algae float body

5. Pump
6. Connection hose 1 m
7. Connecting sleeve in rubber
8. Electric cable
9. Integrated connector

1. Inside of the indoor unit:

a) Both the floating body and the pump next to the drip tray

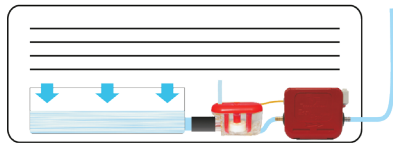

b) Floating body directly on the drip tray, pump next to

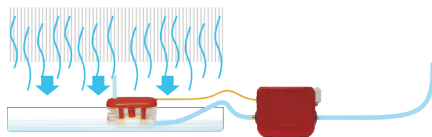

2. Floating body and pump outside the unit

a) Horizontal layout

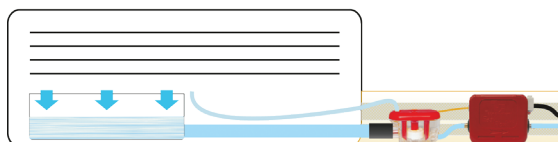

b) Vertical layout

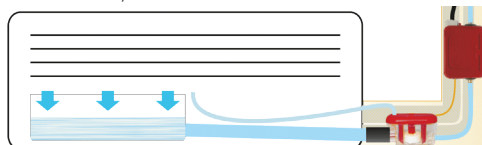

View video



In the indoor unit

View video



In the mounting trough